

SIMONSWERK

METAL CONSTRUCTIONS

KO 40 3D-180

2-part weld-on hinge 3D adjustable with flat tip and stainless steel pin

hinge

Technical details

knuckle length	180,0 mm
knuckle diameter	20,0 mm
material thickness	2,5 mm
pin diameter	10,0 mm

Note

Version with stainless steel pin.

- 3D adjustable (side +/- 1,0 mm, height by 6,0 mm, compression +/- 1,0 mm)

Items (DIN reference: DIN right and left hand)

Finish(es)	steel self colour
packing unit	pack of 10
item number	5 180709 0 00206
Finish(es)	satin brushed stainless steel
packing unit	pack of 10
item number	5 180709 0 04006

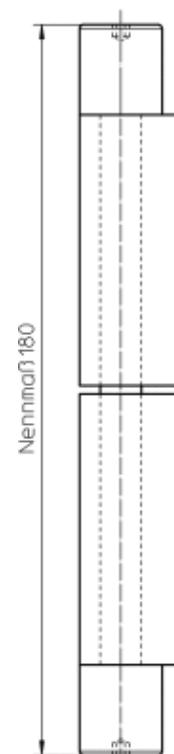

front view

SIMONSWERK

METAL CONSTRUCTIONS

KO 40 3D-180

2-part weld-on hinge 3D adjustable with flat tip and stainless steel pin

hinge

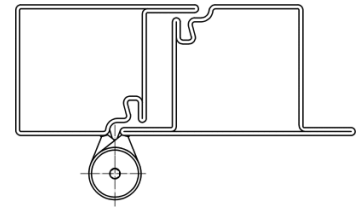

cross section