

# SIMONSWERK

## METAL CONSTRUCTIONS

### KO 41 100

2-part weld-on hinge with round tip and brass pin

#### hinge

#### Technical details

knuckle length	100,0 mm
knuckle diameter	16,0 mm
material thickness	3,0 mm
pin diameter	10,0 mm

#### Note

Version with brass pin and brass raceway.

**Items** (DIN reference: DIN right and left hand)

<b>Finish(es)</b>	steel self colour
<b>packing unit</b>	pack of 25
<b>item number</b>	5 180714 0 00208

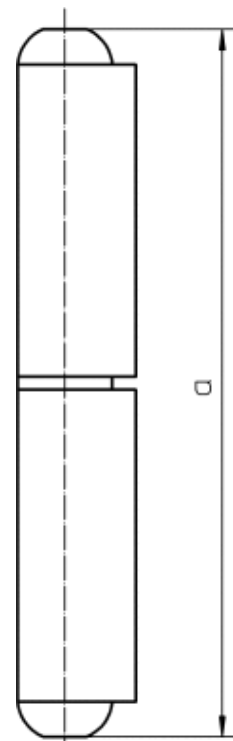

front view

# SIMONSWERK

## METAL CONSTRUCTIONS

### KO 41 100

2-part weld-on hinge with round tip and brass pin

hinge

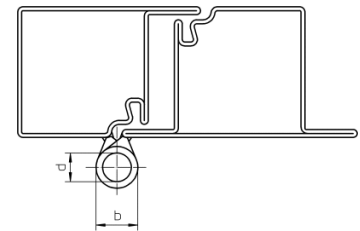

cross section